

Haemonetics TEG6s Patient Test Quick Guide	Q Pulse Reference Number POC-PINS-30	 MAKING EVERY TEST MATTER
Version Number 1.0	Author: Cecilia Anghelescu Authorised by: Haval Ozgun	

Haemonetics TEG6s Patient Test Quick Guide

Start up

Power on device



Power switch on rear panel.
Analyzer will complete power-on-self-test

Enter **Username**, touch **Password** box or  and enter password, then touch **Login**



Failed login - touch **Close** to try again

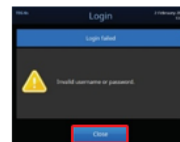

Running Patient Test

1. Select New Test



2. Select patient from list by touching or  for a new patient

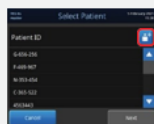

use arrows to scroll

Scan  or enter patient details, then touch **Confirm**

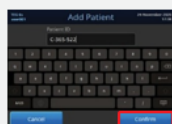

patient details

Confirm Patient Data screen appears (if connected to TEG Manager® & LIS)

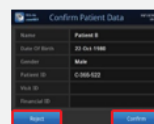

Confirm or Reject

3. Select required cartridge

Ensure correct sample type

Open cartridge pouch



box label



Citrate tube
Required sample type



box label



Heparin tube for Platelet mapping required sample

- Cartridges may be run immediately after removal from the refrigerator
- If error occurs, remove cartridge, rub barcode to remove condensation, wait a minute to warm and then re-run

4. Insert Cartridge



- Barcode to the left as indicated
- Cartridge slot LED flashes until insertion

5. Verify Cartridge and sample type



- CM Citrated K, KH, RT, FF cartridge
- Citrated blood
- Touch **Next** to continue

6. Type optional test information

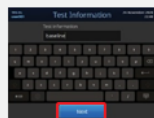

- Leave blank if no text desired
- Touch **Next** to continue

7. Load sample

Dispense sample

Then touch **Start Test**



- Ensure correct blood sample
- Invert sample gently to mix thoroughly



to above indicator arrow



testing commenced

Haemonetics TEG6s Patient Test Quick Guide	Q Pulse Reference Number POC-PINS-30	 MAKING EVERY TEST MATTER
Version Number 1.0	Author: Cecilia Anghelescu Authorised by: Haval Ozgun	

Viewing Results

Results screen

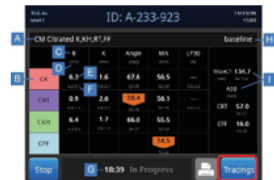

- A - cartridge name
- B - test name
- C - parameter
- D - units
- E - result
- F - reference range
- G - test timer
- H - test information
- I - additional parameters

- Results will replace dashed lines as they are finalized
- Results can be viewed graphically, select Tracings

Group tracings



To access individual tracings:

- Touch a key in legend or cycle through, select Next Tracing

Individual tracings

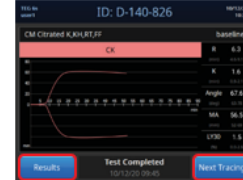

- Touch Next tracing to scroll through tracings
- Touch Results to go back to numerical results

Test Completion

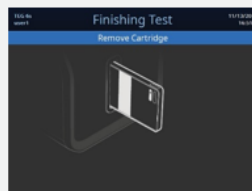

- Test stops automatically when all parameters are finalized
- Remove Cartridge when prompted, cartridge slot LED will also flash



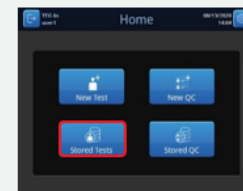

- Stop button now replaced by Done
- Print is now active
- Touch Done to return to home screen



- Touch Stored Tests to view completed tests



Icons

Icons at the top of the screen indicate status of the analyzer.

-  Saving data, upon test completion
-  Remote user logged in, networked
-  Accessed by remote user, locked
-  Data being collected, sample preparation

 Indicates QC overdue

Icons in stored test menu indicate status of test result

-  Test completed, self-terminated
-  Test error or timed out
-  Test manually terminated

Troubleshooting

For all error or alert messages there is an audible tone along with description, number &

-  Error
-  Critical Error
-  Warning

- Record error description and number & follow prompts
- Contact Haemonetics out of hours 24/7 Helpdesk: 0808 234 4817 or POCT department if problem persists

Maintenance



- Wipe and disinfect all external surfaces weekly or more frequently as needed
- Use 70-95% isopropyl alcohol containing solution or commonly used germicidal disposable wipes
- Refer to institutional protocol
- If in doubt check with Haemonetics