

Roche CoaguChek Pro II Quick Guide Patient Testing	Q Pulse Reference Number POC-PINS-15	 MAKING EVERY TEST MATTER
Version Number 1.0	Author Cecilia Anghelescu	

CoaguChek Pro II

Patient Testing



If the function Operator ID is active then log in as the operator and touch 'Patient Test'. If the function Operator ID is inactive, from the Main Menu, touch 'Patient Test'.



If prompted scan the Patient ID or enter via touch screen then touch .



Remove a test strip from pot and insert into meter when prompted.



If prompted insert code chip.



The meter finds the code chip information and warms the strip then displays a 3-minute countdown.

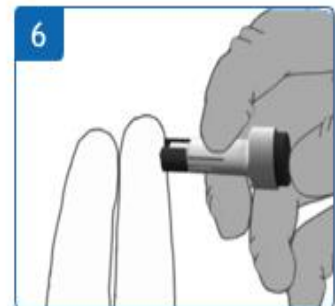

Lance the patient's finger. Exercise precautions required for handling all blood specimens. Operators must wear disposable gloves when collecting blood samples or performing tests.



The patient should then apply the drop of blood to the test strip using top or side dosing, within 15 seconds of lancing finger.



Wait for the meter to beep and start to analyse the sample then remove the finger. The meter will automatically test the on-board QC.



The result is displayed. Comments can be added by touching .